

MANUAL DE INSTALAÇÃO SANTO ANTÔNIO S10 2013...

ITEM	QTD	DESCRIÇÃO
A	01	lateral sto. antônio esq.
B	01	lateral sto. antônio dir.
C	01	arco sto. antônio
D	20	parafuso telep M8 x 25mm
E	02	rebite M6
F	02	parafuso M6 x 20mm
G	20	arruela lisa M8
H	02	arruela pressão M6
I	02	arruela lisa M6
J	04	suporte 01
K	02	suporte 02

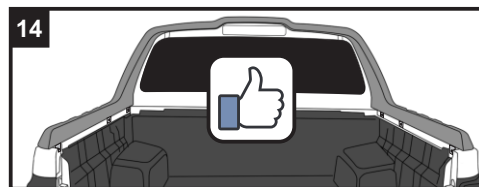

Componentes:

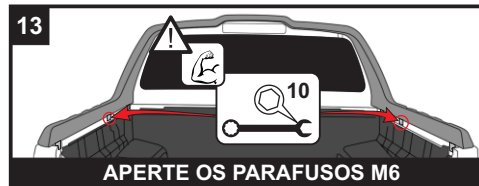
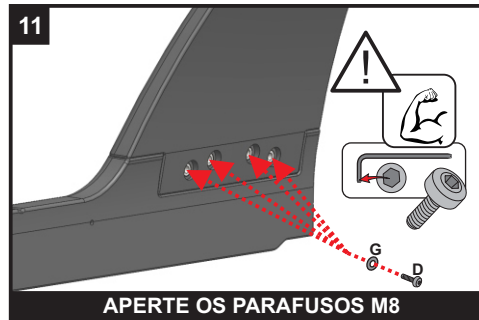
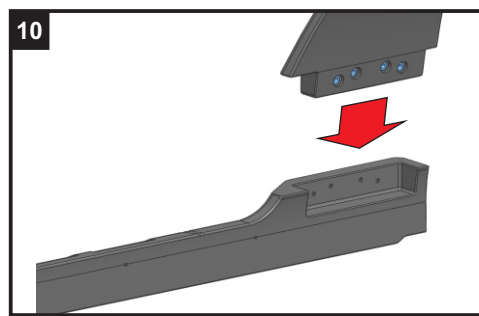
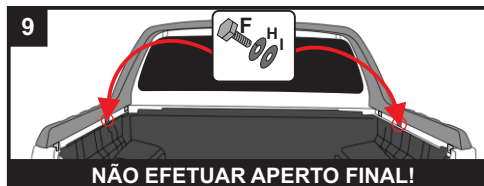
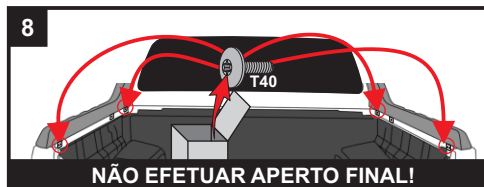
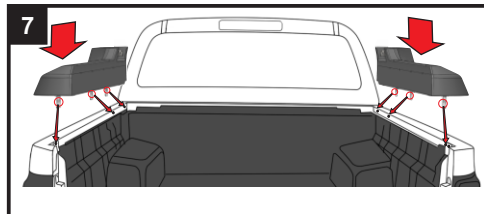
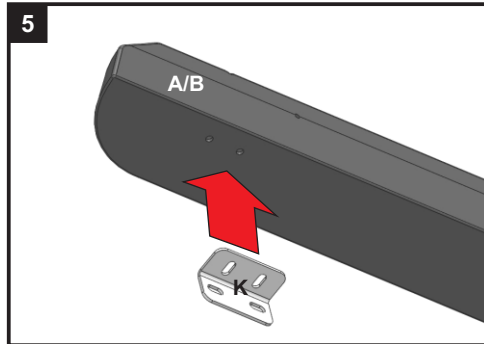
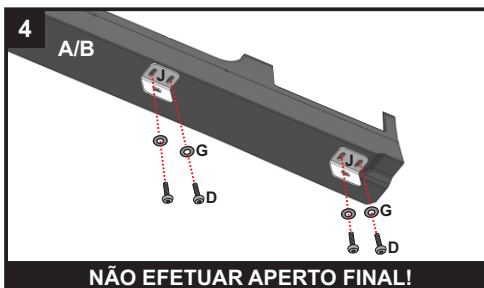
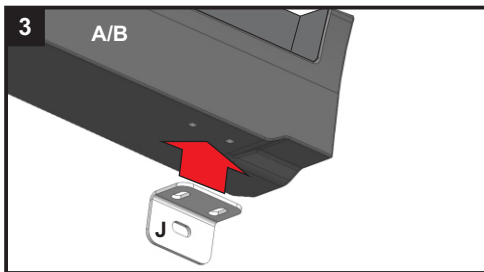
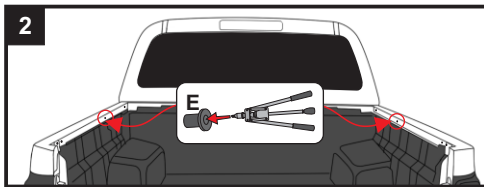
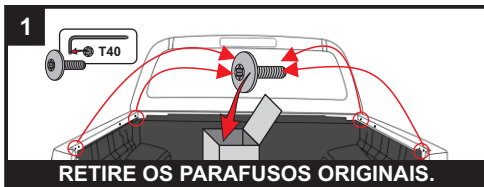
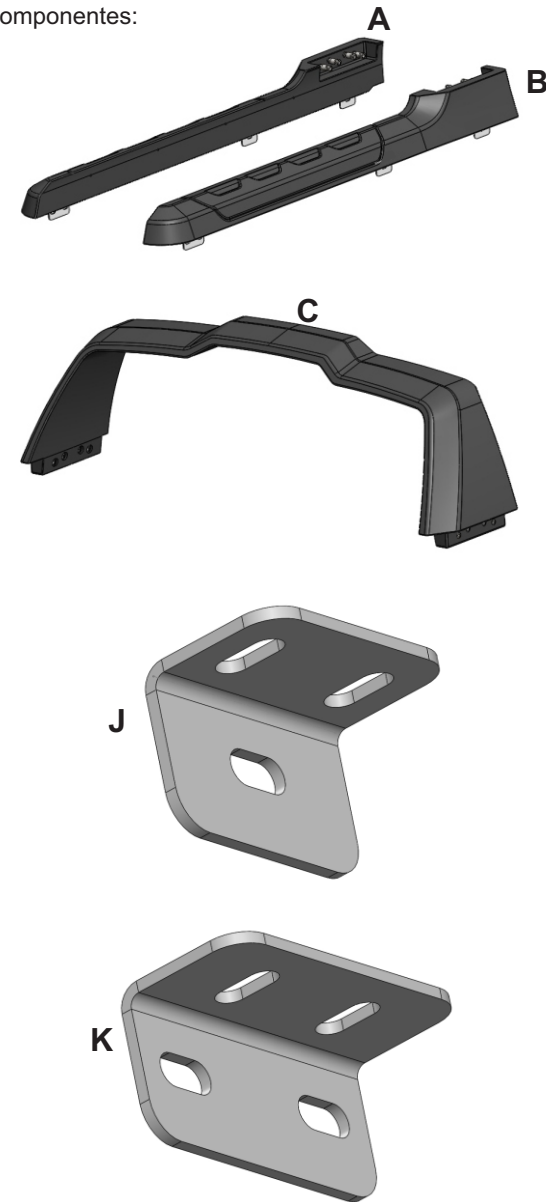

TUDO ACESSÓRIO DEVE SER LAVADO COM ÁGUA E SABÃO, E UMA ESPONJA OU FLANELA. EVITAR PRODUTOS QUÍMICOS E ABRASIVOS

